

Our references and past “masterpiece projects”

Confidential

Selection of projects of Analyzer House (1/5)

Industrial Processes and Automation: “Walk-in” Analyzer Houses

Analyzer House L=6m



Analyzer House L=4-5m



Our references and past “masterpiece projects”

Selection of projects of Analyzer House (2/5)

Confidential

Industrial Processes and Automation: “Walk-in” Analyzer Houses

Analyzer House L=3,5m



Analyzer House L=6,5m



Our references and past “masterpiece projects”

Confidential

Selection of projects of Analyzer House (3/5)

Example of our “way of work” on complex requirement ...

Industrial Processes and Automation: “Walk-in” Analyzer Houses

Analyzer House L= 2,5m x 2,4m x 4,0 m (#2)
Currently in our «Shop floor»

Client's requirements

Engineering study for meeting “hurricane” solicitation

3D CAD design compliant to Engineering study (for customer approval)

Shop floor execution

Analyzer House must withstand a wind solicitation of **240 Km/h** (Hurricane)

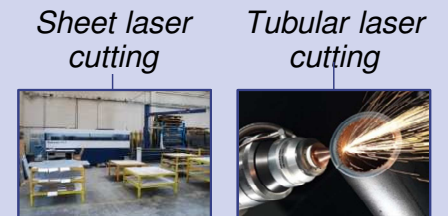
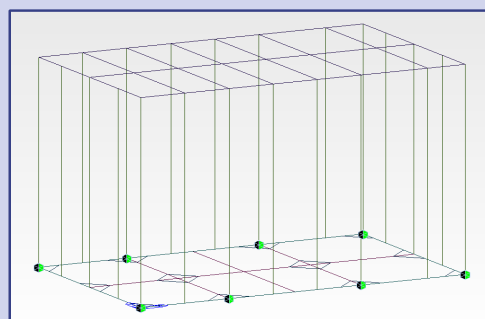
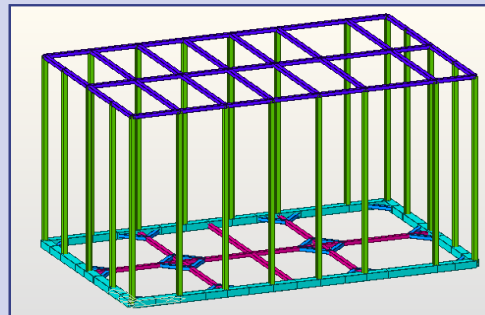

Welding

Our references and past “masterpiece projects”

Confidential

Selection of projects of Analyzer House (4/5)

... and the final outcome of our operations – Hurricane-proof Shelter

Industrial Processes and Automation: “Walk-in” Analyzer Houses

Analyzer House L= 2,5m x 2,4m x 4,0 m (#2)
Currently in our «Shop floor»

**3D CAD design compliant
to Engineering study**
(for customer approval)



Shop floor execution

Sheet laser
cutting



Tubular laser
cutting



Bending



Welding

Final Product



Our references and past “masterpiece projects”

Selection of projects of Analyzer House (5/5)

Our “way of work” for REI 120 (Standard Fire) / H60 (Hydrocarbon Fire) Shelter

